

# Z 30

## User's Manual (with Warranty)

- Read this document thoroughly before using the camera.
- To ensure proper use of the camera, be sure to read "For your safety" (overleaf).
- After reading this document, keep it readily accessible for future reference.

No reproduction in any form of this document, in whole or in part (except for brief quotation in critical articles or reviews), may be made without written authorization from NIKON CORPORATION.



### Nikon Europe Service Warranty Card

Model name <b>Nikon Z 30</b>	Serial No.
Name and address of customer	Purchase date
Dealer	
Distributor Nikon Europe B.V. The Garden, Stroombaan 14, 1181 VX Amstelveen, The Netherlands	
Manufacturer NIKON CORPORATION 1-5-20, Nishio, Shinagawa-ku, Tokyo 140-8601, Japan	

#### Warranty terms - Nikon Europe service warranty

Dear Nikon customer,  
We thank you for your purchasing this Nikon product. Should your Nikon product require warranty service, please contact the dealer from whom it was purchased or a member of our authorized service network within the sales territory of Nikon Europe B.V. (e.g. Europe/others). See details under: <https://www.nikoneurope.com>

In order to avoid any unnecessary inconvenience, we advise you to read the user manuals carefully before contacting the dealer or our authorized service network.

Your Nikon equipment is guaranteed against any manufacturing defects for one full year from the date of original purchase. If during this period of guarantee the product proves defective due to improper material or workmanship, our authorized service network within the sales territory of Nikon Europe B.V. will, without charge for labor and parts, repair the product in the terms and conditions set as below. Nikon reserves the right (at its sole discretion) to replace or repair the product.

1. This warranty is only provided upon presentation of the completed warranty card and original invoice or purchase receipt indicating the date of purchase, product type and dealer's name, together with the product. Nikon reserves the right to refuse free-of-charge warranty service if the above documents cannot be presented or if the information contained in it is incomplete or illegible.

2. This warranty will not cover:

- necessary maintenance and repair or replacement of parts due to normal wear and tear.
- modifications to upgrade the product from its normal purpose as described in user manuals, without the prior written consent of Nikon.
- transport costs and all risks of transport relating directly or indirectly to the warranty of the products.
- any damage resulting from modifications or adjustments which may be made to the product, without the prior written consent of Nikon, in order to comply with local or national technical standards in force in any other country than the ones for which the product was originally designed and/or manufactured.

3. The warranty will not be applicable in the case of:

- damage caused by misuse including but not limited to failure to use the product for its normal purpose or according to the user instructions on the proper use and maintenance, and to installation or use of the product inconsistent with the safety standards in force in the country where it is used.
- damage caused by accidents including but not limited to lightning, water, fire, misuse or neglect.
- defacing, illegibility or removal of the model or serial number on the product.
- damage resulting from repairs or adjustments which have been conducted by unauthorized service organizations or persons.
- defects in any system into which the product is incorporated or with which it is used.

4. This service warranty does not affect the consumer's statutory rights under applicable national laws in force, nor the consumer's right against the dealer arising from their sales/purchase contract.

**Notice:** An overview of all authorized Nikon Service Stations can be found online by following this Link (URL = <https://www.nikoneurope.com>).

Z 30 Model Name: N2121

**Nikon user support**  
Should you need technical support, we offer a number of options.

- **For users in the U.S.A.:** <https://www.nikonusa.com/>
- **For users in Canada:** <https://www.nikon.ca/>
- **For users in Mexico:** <https://www.nikon.com.mx/>
- **For users in Latin America:** <https://www.nikonamericalatina.com/>
- **For users in Europe:** <https://www.nikoneurope.com>
- **For users in Asia, Oceania, the Middle East, and Africa:** <https://www.nikon-asia.com/>

The Z 30 User's Manual and Reference Guide

In addition to this *User's Manual*, a *Reference Guide* is available for your camera.

- **The User's Manual (this sheet)**  
The *User's Manual* describes basic camera operations.
- **The Reference Guide**  
Camera features and operations are detailed in a *Reference Guide*, a supplement to the *User's Manual*. The *Reference Guide* can be viewed on computers, smartphones, and tablets.

nikon reference guide Z 30

<https://onlinemanual.nikonimglib.com/z30/en/>

**✓ Lens kit lenses**  
For information on lenses supplied as part of a lens kit, see the lens documentation available for download from the Nikon Download Center.

**✓ The Nikon Download Center**  
Visit the Nikon download center to download the latest firmware for cameras and lenses, NX Studio and other Nikon software, and documentation for Nikon products including cameras, NIKKOR lenses, and flash units. <https://downloadcenter.nikonimglib.com/>

**✓ Genuine Nikon software**  
Nikon computer software such as NX Studio is available from the Nikon Download Center. For more information, see the "Reference Guide".

#### Package contents

Be sure all items listed here were included with your camera.

- Camera
- BF-N1 body cap
- EN-EL25a rechargeable Li-ion battery
- Strap
- Warranty (see left)
- User's Manual (this sheet)
- UC-E24 USB cable

- Memory cards are sold separately.
- Purchasers of the lens kit option should confirm that the package also includes a lens.
- This camera uses SD, SDHC, and SDXC memory cards, referred to throughout this document as "memory cards".

#### Parts of the camera

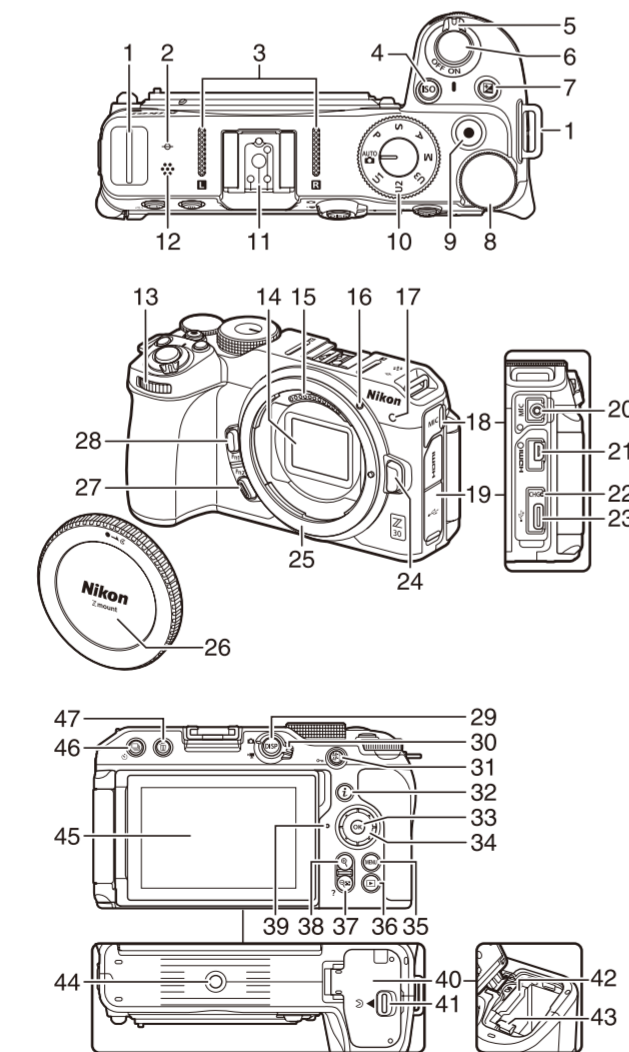

- |   |   |
|---|---|
| 1 Eyelief for camera strap                  | 24 Lens release button                          |
| 2  (focal plane mark)                       | 25 Lens mount                                   |
| 3 Stereo microphone                         | 26 Body cap                                     |
| 4 ISO button                                | 27 Fn2 button                                   |
| 5 Power switch                              | 28 Fn1 button                                   |
| 6 Shutter-release button                    | 29 DISP button                                  |
| 7  button                                   | 30 Photo/video selector                         |
| 8 Main command dial                         | 31  button                                      |
| 9 Video-record button                       | 32  button                                      |
| 10 Mode dial                                | 33  button                                      |
| 11 Accessory shoe (for optional flash unit) | 34 Multi selector                               |
| 12 Speaker                                  | 35 MENU button                                  |
| 13 Sub-command dial                         | 36  button                                      |
| 14 Image sensor                             | 37  button                                      |
| 15 CPU contacts                             | 38  button                                      |
| 16 Battery-mounting mark                    | 39 Memory card access lamp                      |
| 17 REC lamp                                 | 40 Battery-chamber/memory card slot cover       |
| 18 Self-timer lamp                          | 41 Battery-chamber/memory card slot cover latch |
| 19 Cover for microphone connector           | 42 Memory card slot                             |
| 20 Cover for HDMI and USB connectors        | 43 Battery latch                                |
| 21 Connector for external microphone        | 44 Tripod socket                                |
| 22 HDMI connector                           | 45 Monitor                                      |
| 23 USB connector                            | 46  button                                      |
|   | 47  button                                      |

• Throughout this document, the display in camera monitor during shooting is referred to as the "shooting display".

#### First steps

##### Attaching the strap

To attach a strap (whether the supplied strap or one that has been purchased separately):

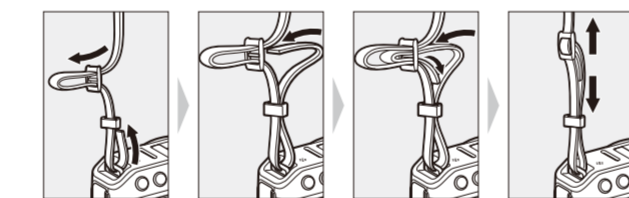

##### Inserting the battery and a memory card

- Turn the camera off before inserting or removing the battery and memory card.
- Using the battery to keep the orange battery latch pressed to one side, slide the battery into the battery chamber until the latch locks it in place.
- Holding the memory card in the orientation shown, slide it straight into the slot until it clicks into place.

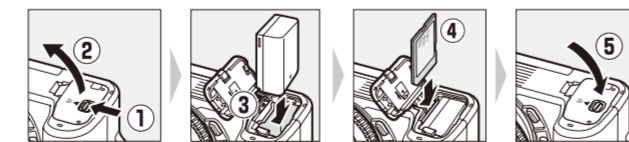

##### Charging the battery

Fully charge the supplied EN-EL25a battery before use. With the battery inserted in the camera, connect the camera to the optional EH-8P AC adapter using the separately sold UC-E25 USB cable (featuring Type C connectors at both ends) to charge the battery. • The EH-8P AC adapter cannot be connected using the supplied USB cable.

- ✓ **Battery care**  
Read and follow the warnings and cautions in "For your safety" (overleaf) and "Caring for the camera and battery: Cautions" (overleaf).

- 1 Insert the EN-EL25a into the camera.
- 2 After confirming that the camera is off, connect the camera and the optional EH-8P AC adapter (1) using the optional UC-E25 USB cable (featuring Type C connectors at both ends). Connect the power plug of the AC adapter to a household electrical outlet. The battery charges while the camera is off. Keep the plug straight during insertion and removal.

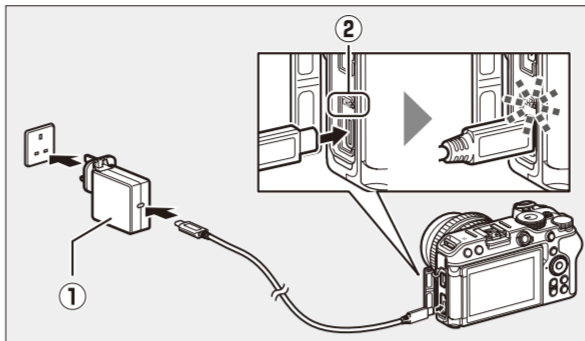

- The camera charge lamp (2) lights amber while charging is in progress. The lamp turns off when charging is complete.
- An exhausted battery will fully charge in about 2 hours.
- When charging is complete, disconnect the USB cable. Be sure to keep the connectors straight when disconnecting them.
- The shape of the plug varies with the country or region of purchase.

- ✓ **Cautions: Charging**  
If the battery cannot be charged using the AC adapter, for example because the battery is not compatible or the temperature of the camera is elevated, the charge lamp will flash rapidly for about 30 seconds and then turn off. If the charge lamp is off and you did not observe the battery charging, turn the camera on and check the battery level.

- ✓ **Charging with third-party AC adapters that are equipped with USB Type C connectors and are compliant with PD (power delivery) standards**  
• The camera battery can also be charged with third-party AC adapters. Use an AC adapter that complies with USB PD (power delivery) standards and is equipped with USB Type C connectors.
- Use an AC adapter that supports output of 15 W (5 V/3 A) or more.
- Use a USB cable that is Type C on both ends to connect to the camera.
- We do not guarantee that all third-party AC adapters and USB cables are able to charge the camera battery.

- ✓ **Connecting to a computer to charge the camera battery**  
• You can also connect the camera with a computer using the supplied USB cable to charge the battery inserted in the camera.
- Turn on the computer before charging. The battery charges while the camera is off.
- Depending on the model and product specifications, some computers will not supply current to charge the camera.

##### Attaching a lens

- The camera can be used with Z mount lenses. The lens generally used in this document for illustrative purposes is a NIKKOR Z DX 16–50mm f/3.5–6.3 VR.
- Be careful to prevent dust entering the camera.
- Confirm that the camera is off before attaching the lens.
- Remove the camera body cap (1, 2) and rear lens cap (3, 4).

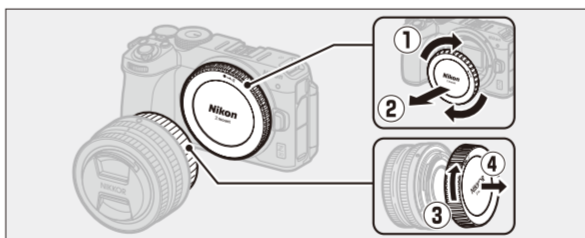

Align the mounting marks on the camera (5) and lens (6). Do not touch the image sensor or lens contacts.

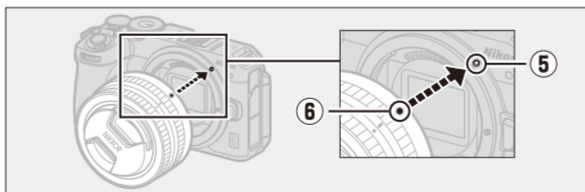

Rotate the lens as shown until it clicks into place (7).

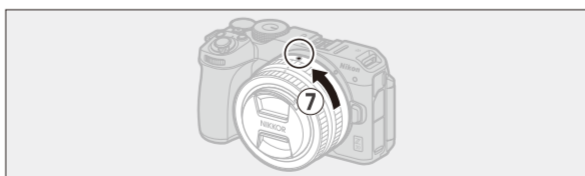

- Remove the front lens cap before taking pictures.

- ✓ **F mount lenses**  
• Be sure to attach the FTZ II/FTZ mount adapter (available separately) before using F mount lenses.
- Attempting to attach F mount lenses directly to the camera could damage the lens or image sensor.

- **Detaching lenses**  
• After turning the camera off, press and hold the lens release button while turning the lens in the direction opposite that of attachment to detach the lens.
- After removing the lens, replace the lens caps and camera body cap.

##### Opening the monitor

Slowly rotate the monitor without using excessive force.

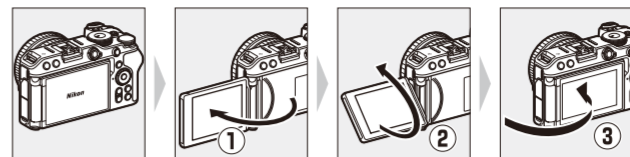

##### Turning on the camera

When the camera is turned on for the first time, the language selection screen is displayed. Choose a language and then set the camera clock (no other operations can be performed until the clock is set).

- 1 Turn the camera on.

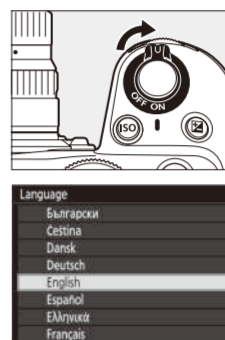

- The [Language] selection screen will be displayed.

- 2 Select a language.

- Press or to highlight the desired language and press (the languages available vary with the country or region in which the camera was originally purchased).
- The [Time zone] screen will be displayed.

- 3 Choose a time zone.

- Press or to choose a time zone and press .
- The display shows the selected cities in the chosen zone and the difference between the time in the chosen zone and UTC.
- The [Date format] screen will be displayed.

- 4 Choose a date format.

- Highlight the desired date (year, month, and day) display order and press .
- The [Daylight saving time] screen will be displayed.

- 5 Turn daylight saving time on or off.

- Highlight [On] (daylight saving time on) or [Off] (daylight saving time off) and press .
- Selecting [On] advances the clock one hour; to undo the effect, select [Off].
- The [Date and time] screen will be displayed.

- 6 Set the clock.

- Press or to highlight date and time items and press or to change them.
- Press to confirm the date and time setting.
- The message [Done.] will be displayed and the camera switches to shooting mode.

##### Taking photographs easily (AUTO auto)

- ✓ **Lenses with retractable barrels**  
Lenses with retractable barrels must be extended before use. Rotate the zoom ring as shown until the lens clicks into the extended position.

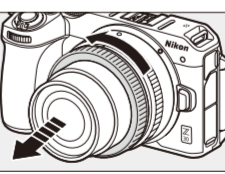

- 1 Select photo mode by rotating the photo/video selector to .

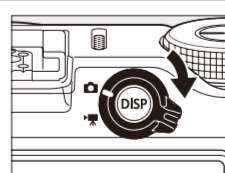

- 2 Rotate the mode dial to .

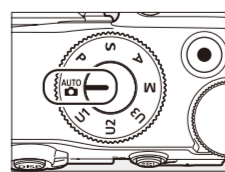

- 3 Ready the camera.



- 4 Frame the photograph.

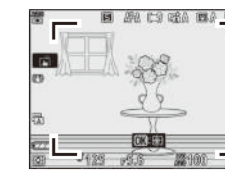

- 5 Press the shutter-release button halfway to focus.



- 6 Smoothly press the shutter-release button the rest of the way down to take the photograph.



##### Recording videos easily (AUTO auto)

- 1 Select video mode by rotating the photo/video selector to .

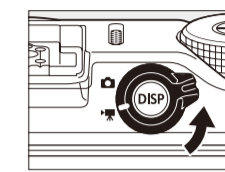

- 2 Rotate the mode dial to .

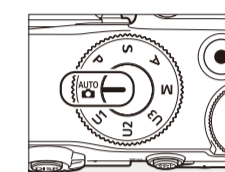

- 3 Press the video-record button to start recording.

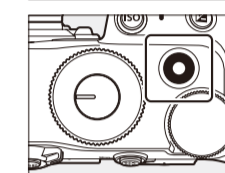

- The REC lamp will light and a recording indicator (1) will be displayed in the monitor. The monitor also shows the time remaining, or in other words the approximate amount of new footage that can be recorded to the memory card (2).

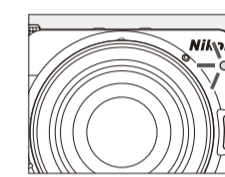

- 4 Press the video-record button again to end recording.

##### Viewing photos

Press the button to view photos and videos recorded with the camera on the monitor.

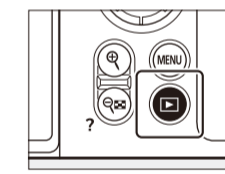

- Press or , or flick left or right on the monitor to view other images.
- Videos are indicated by a icon at the upper left of the monitor. Press the button, or tap the icon in the monitor to play back videos.
- To end playback and return to shooting mode, press the shutter-release button halfway.

##### Caring for the camera

- **Storage**  
When the camera will not be used for an extended period, remove the battery. Before removing the battery, confirm that the camera is off. Do not store the camera in locations that:
- are poorly ventilated or subject to humidities of over 60%
- are next to equipment that produces strong electromagnetic fields, such as televisions or radios
- are exposed to temperatures above 50 °C (122 °F) or below -10 °C (14 °F)

##### Troubleshooting

You may be able to resolve any issues with the camera by following the steps below. Check this list before consulting your retailer or Nikon-authorized service representative.

- STEP 1** Check the list of common problems. Common problems and solutions are listed in the troubleshooting section of the *Reference Guide*.
- STEP 2** Turn the camera off and remove the battery, then wait about a minute, re-insert the battery and turn the camera on. ✓ The camera may continue to write data to the memory card after shooting. Wait at least a minute before removing the battery.
- STEP 3** Search Nikon websites. For support information and answers to frequently asked questions, visit the website for your country or region (see "Nikon user support" at the top left corner of this page). To download the latest firmware for your camera, visit: <https://downloadcenter.nikonimglib.com/>
- STEP 4** Consult a Nikon-authorized service representative.

