

## AIR CIRCULATION FAN

# USER MANUAL

MSFAT06R6WW

Warning notices: Before using this product, please read this manual carefully and keep it for future reference. The design and specifications are subject to change without prior notice for product improvement. Consult with your dealer or manufacturer for details.

The diagram above is just for reference. Please take the appearance of the actual product as the standard.

## **THANK YOU LETTER**

Thank you for choosing Midea! Before using your new Midea product, please read this manual thoroughly to ensure that you know how to operate the features and functions that your new appliance offers in a safe way.

# CONTENTS

<b>THANK YOU LETTER</b>	01
<b>SAFETY INSTRUCTIONS</b>	02
<b>SPECIFICATIONS</b>	05
<b>PRODUCT OVERVIEW</b>	06
<b>QUICK START GUIDE</b>	07
<b>OPERATION INSTRUCTIONS</b>	09
<b>CLEANING AND MAINTENANCE</b>	15
<b>TROUBLESHOOTING</b>	20
<b>TRADEMARKS, COPYRIGHTS AND LEGAL STATEMENT</b>	21
<b>DATA PROTECTION NOTICE</b>	22

# SAFETY INSTRUCTIONS

## Intended Use

The following safety guidelines are intended to prevent unforeseen risks or damage from unsafe or incorrect operation of the appliance. Please check the packaging and appliance on arrival to make sure everything is intact to ensure safe operation. If you find any damage, please contact the retailer or dealer. Please note modifications or alterations to the appliance are not allowed for your safety concern. Unintended use may cause hazards and loss of warranty claims.

## Explanation of Symbols



### **Danger**

This symbol indicates that there are dangers to the life and health of persons due to extremely flammable gas.



### **Warning of electrical voltage**

This symbol indicates that there is a danger to life and health of persons due to voltage.



### **Warning**

The signal word indicates a hazard with a medium level of risk which, if not avoided, may result in death or serious injury.



### **Caution**

The signal word indicates a hazard with a low degree of risk which, if not avoided, may result in minor or moderate injury.



### **Attention**

The signal word indicates important information (e.g., damage to property), but not danger.



### **Observe instructions**

This symbol indicates that a service technician should only operate and maintain this appliance in accordance with the operating instructions.

Read these operating instructions carefully and attentively before using/commissioning the unit and keep them in the immediate vicinity of the installation site or unit for later use!

# READ AND SAVE THESE INSTRUCTIONS

## **⚠ CAUTION**

- Read rules for safe operation and instructions carefully.
- This appliance is not intended for use by persons (including children) with reduced physical, sensory or mental capabilities, or lack of experience and knowledge, unless they have been given supervision or instruction concerning use of the appliance by a person responsible for their safety. Children should be supervised to ensure that they do not play with the appliance.
- Never insert fingers, pencils, or any other object through the grille when fan is running.
- Disconnect fan when moving from one location to another.
- Be sure fan is on a stable surface when operating to avoid overturning.
- Keep electrical appliances out of reach from children or infirm persons. Do not let them use the appliances without supervision.
- Household use only.

## **⚠ WARNING**

- If the supply cord is damaged, it must be replaced by manufacturer or its service agent or a similarly qualified person in order to avoid a hazard.
- To protect against the risk of electrical shock, do not immerse the unit, cord or plug in water or other liquid.
- When the appliance is not in use and before cleaning, unplug the appliance from the outlet.
- When the fan was assembled, the rotor blade guard shall not be taken off anymore.

- This appliance has a polarized plug (one blade is wider than the other). To reduce the risk of electric shock, this plug is intended to fit in a polarized outlet only one way. If the plug does not fit fully in the outlet, reverse the plug. If it still does not fit, contact a qualified electrician. Do not attempt to defeat this safety feature.
- **WARNING**—To reduce the risk of fire or electric shock, do not use this fan with any solid-state speed control device.
- Do not leave the fan running unattended.
- To Reduce The Risk Of Fire, Electric Shock Or Injury To Persons, Do Not Use Replacement Parts That Have Not Been Recommended By The Manufacturer (e.g.Parts Made At Home Using A 3D Printer).
- Do not operate any fan with a damaged cord or plug.
- Discard fan or return to an authorized service facility for examination and/or repair.
- Do not run cord under carpeting. Do not cover cord with throw rugs, runners, or similar coverings. Do not route cord under furniture or appliances. Arrange cord away from traffic area and where it will not be tripped over.
- This product employs overload protection (fuse). A blown fuse indicates an overload or short-circuit situation. If the fuse blows, unplug the product from the outlet. Replace the fuse as per the user servicing instructions (follow product marking for proper fuse rating) and check the product. If the replacement fuse blows, a short-circuit may be present and the product should be discarded or returned to an authorized service facility for examination and/or repair.
- The fan shall not be modified by user. such as by adding supplemental filters to fans not intended to be used for air cleaning purposes.

# SPECIFICATIONS

<b>Product Model</b>	<b>MSFAT06R6WW</b>
Power supply	120V- 60Hz
Power	35W

# PRODUCT OVERVIEW

## Name of Part

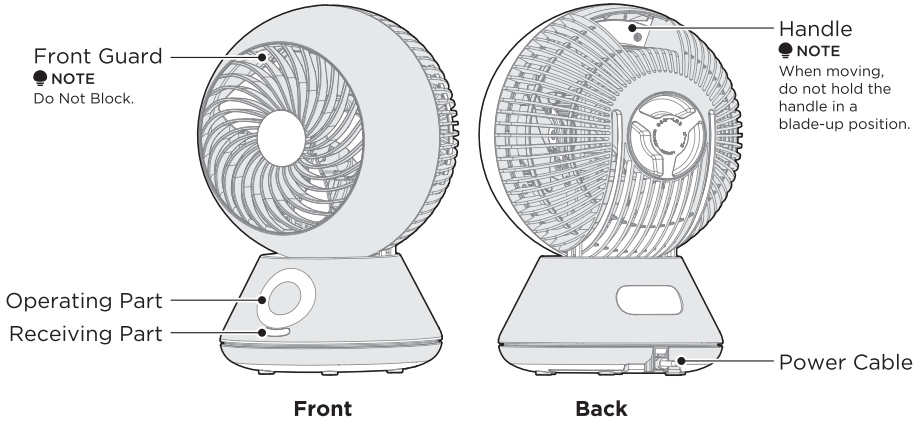

## Part List

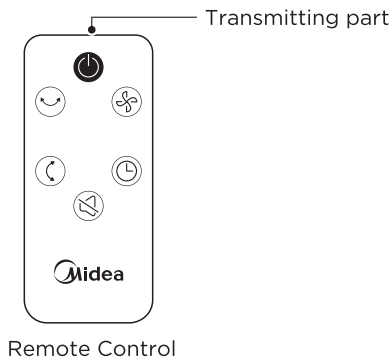

### ● NOTE

The air circulation fan adopts a structure that enhances the straightness of the wind so that the air can be circulated and stirred. Therefore, compared with ordinary electric fans, the sound of blowing air will be slightly louder.

# QUICK START GUIDE

## Preparation of Remote Control

Insert the supplied battery (CR2032 button battery) into the battery holder of the remote control.



## How to Install the Battery (How to Replace)

1. Press the claw in the direction of the arrow to pull out the battery holder.
2. Install the new battery on the battery holder with the correct orientation, and insert it into the remote control.

- The state of the remote control facing inward.

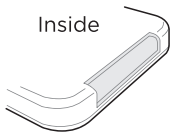
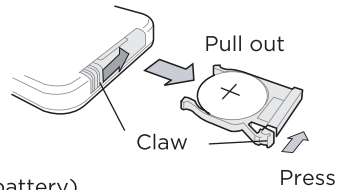

- Do not reverse the inside and outside of the battery.

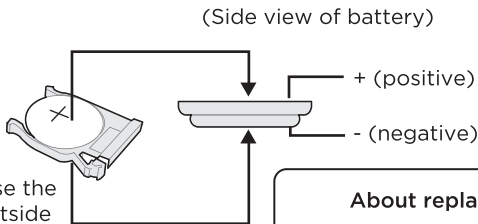

**About replacement batteries**  
The battery is a consumable. Please purchase a commercially available button battery CR2032.

The remote control may not be able to be operated in the following cases.

- When there is an obstacle between the receiver of the main unit and the remote control.
- When using inverter lighting equipment or electronic instant lighting equipment.
- When the receiving part of the main unit is exposed to strong light such as sunlight.

**TIPS**

- Once the battery is depleted, the operable range of the remote control will be reduced.  
In this case, please replace the battery.
- Do not damage the transmitting part of the remote control.
- When the remote control is not used for a long time, the battery should be removed from the remote control to avoid battery leakage.
- Keep the battery out of reach of infants and young children.  
There is a possibility of swallowing the battery.

**⚠ WARNING**

- **INGESTION HAZARD:** This product contains a button cell or coin battery.
- **DEATH** or serious injury can occur if ingested.
- A swallowed button cell or coin battery can cause **Internal Chemical Burns** in as little as **2 hours**.
- **KEEP** new and used batteries **OUT OF REACH** of **CHILDREN**.
- **Seek immediate medical attention** if a battery is suspected to be swallowed or inserted inside any part of the body.



- a) Remove and immediately recycle or dispose of used batteries according to local regulations and keep away from children.  
Do NOT dispose of batteries in household trash or incinerate.
- b) Even used batteries may cause severe injury or death.
- c) Call a local poison control center for treatment information.
- d) Compatible battery type: CR2032
- e) Nominal battery voltage: 3.0V
- f) Non-rechargeable batteries are not to be recharged.
- g) Do not force discharge, recharge, disassemble, heat above 60°C or incinerate. Doing so may result in injury due to venting, leakage or explosion resulting in chemical burns.
- h) Ensure the batteries are installed correctly according to polarity(+ and -).
- i) Do not mix old and new batteries, different brands or types of batteries, such as alkaline, carbon-zinc, or rechargeable batteries.
- j) Remove and immediately recycle or dispose of batteries from equipment not used for an extended period of time according to local regulations.
- k) Always completely secure the battery compartment. If the battery compartment does not close securely, stop using the product, remove the batteries, and keep them away from children.

# OPERATION INSTRUCTIONS

## How to Use

Operations on the main body operating part are explained.  
You can also perform the same operation with the remote control.

### 1. Insert the power plug into the socket

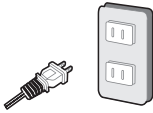

Please insert it all the way in.

- The buzzer sounds, and all the indicators light up for about 1 second.

### 2. Press the power button to start running

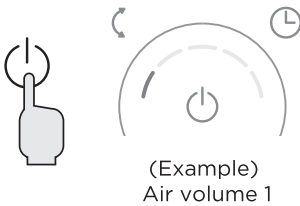

The air volume indicator lights up and the air blows.  
Press the power button again to stop.

### 3. Adjust the air volume

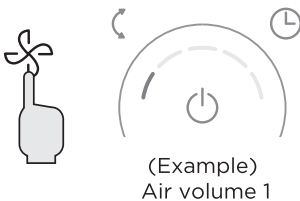

Each time you press the air volume button, you can switch the blowing intensity in 5 levels, and the air volume indicator light corresponding to the air volume will light up.

Wind strength	1	2	3	4	5
	Weak				Strong

#### 4. Up/down left/right oscillator

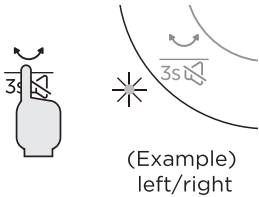
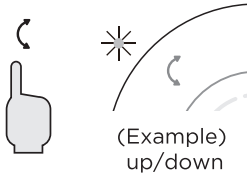

Each time you press the oscillator button, you can switch the oscillator direction, and the indicator light corresponding to the direction lights up.

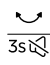
- Press the  button on the remote control.
- Press and hold  button for 3 seconds to mute the device.

When the oscillator is running, there will be click sound. This is the unique sound of the oscillator motor, and it does not mean that the product is abnormal.

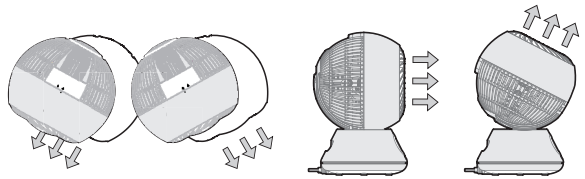

#### 5. Schedule off operation setting time: 1•2•4•8 hours

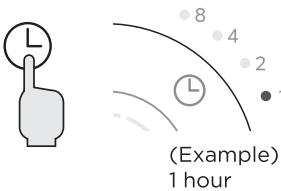

Press the schedule off button during operation to set the schedule off (the time can be set to 1-15h hours). The indicator light corresponding to the set time lights up.

- If you want to cancel the schedule off setting, please press the schedule off button to turn off the schedule off indicator.  
Or press the power button to stop, turn on and restart.
- When schedule off isn't turned on, functions cannot be set in power-off state.

#### 6. After use, use the power button to stop the operation, and pull out the power plug from the socket.

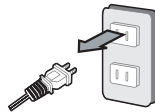

### Forced Stop

- If the fan runs continuously for 24 hours without any operation, it will automatically enter off.

## Setting Place

Please install it on a level floor or table without obstacles.

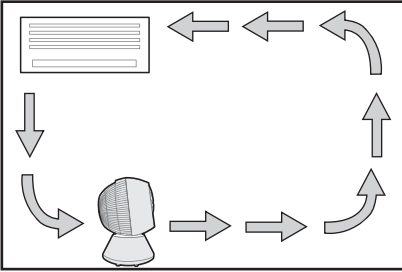

During cooling

Diffuses the cold air accumulated on the floor and circulates repeatedly in the room.

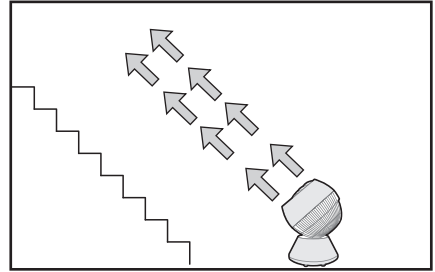

During heating

Sends air to the roof and recirculates the upper heating in the room.

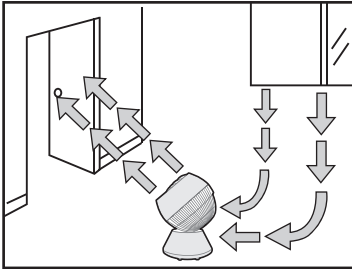

For ventilation (stationary operation)

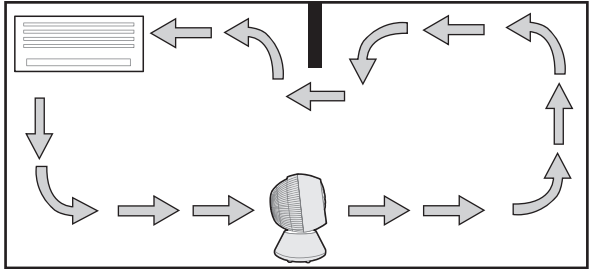



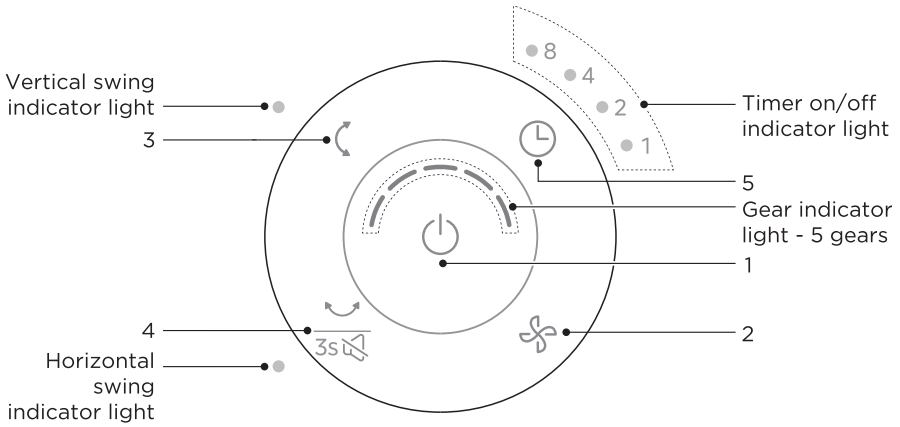

Dual room circulation (stationary operation)

- If a wide range of air supply is required, it will be more effective to use the oscillator operation.

## Operating Part



No	Button	Function Description
1	 ON/OFF	<ul style="list-style-type: none"> <li>• Tap to turn the fan on/off.</li> </ul>
2	 Wind speed	<ul style="list-style-type: none"> <li>• Tap to change the wind speed from 1 (low) to 5 (high).</li> </ul>
3	 Vertical swing button	<ul style="list-style-type: none"> <li>• Press the button to turn on/off vertical swing</li> </ul>
4	 Horizontal swing/mute button	<ul style="list-style-type: none"> <li>• Turn on/off horizontal swing</li> <li>• Press and hold the button for 3s until there is a long beep to turn on/off the mute function.</li> </ul>
5	 Schedule on/off button	<ul style="list-style-type: none"> <li>• Press to set 1-15 hours schedule on/off.</li> <li>• Schedule time indicator light effect, ○ indicates on: <ul style="list-style-type: none"> <li><b>1h</b> ●8●4●2○1    <b>2h</b> ●8●4○2●1    <b>3h</b> ●8●4○2○1</li> <li><b>4h</b> ●8○4●2●1    <b>5h</b> ●8○4●2○1    <b>6h</b> ●8○4○2●1</li> <li><b>7h</b> ●8○4○2○1    <b>8h</b> ○8●4●2●1    <b>9h</b> ○8●4●2○1</li> <li><b>10h</b> ○8●4○2●1    <b>11h</b> ○8●4○2○1    <b>12h</b> ○8○4●2●1</li> <li><b>13h</b> ○8○4●2○1    <b>14h</b> ○8○4○2●1    <b>15h</b> ○8○4○2○1</li> </ul> </li> </ul>

## Remote Control

- Use of the remote control. Please refer to the panel operation and display section for the button functions of the remote control.
- The remote control can be used in front of the product within 9.8 ft.

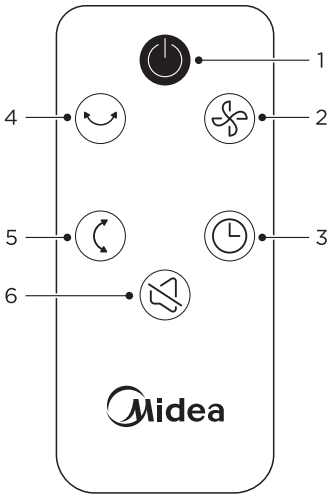

No	Button	Function Description
1		• Tap to turn the fan on/off.
2		• Tap to change the wind speed from 1 (low) to 5 (high).
3		• Set timer to turn the fan on/off.
4		• Turn on/off horizontal swing
5		• Press the button to turn on/off vertical swing.
6		• Press the button to turn on/off the mute function.

## About Oscillator Function

- The oscillator mechanism is composed of a special motor and other connecting parts. When the oscillator is running, there will be a motor operation sound (squeak or click sound), but this is not a problem of the product.
- If there is an abnormal sound, please contact the place of purchase or the customer service center.
- During the oscillator operation, please do not move the main unit.  
A load may be applied to the connection part or the motor, resulting in failure.

## About Memory Function

### • Power-off memory function

When the power of the fan is turned off, it will automatically remember the speed and mode settings used last time. The fan will automatically restore to the previous setting state the next time it is turned on.

When the fan unexpectedly shuts down due to sudden power failure or other reasons, this product can automatically record the fan speed and mode settings from the last use. When the fan is turned on again, it will automatically restore to the previous setting state, without the need to reset.

## Precautions For Long-term Use

Fans that have been used for many years may cause deterioration of internal parts due to the influence of heat, moisture, dust, etc., which may cause smoke and fire. If the following situations occur during use, please immediately turn off the operation switch, pull out the power plug from the socket, and contact the store where you purchased the product or the Customer Service registered in the terms of after-sales service.

- The impeller does not rotate when the switch is turned on.
- Impeller rotates but very slowly and irregularly.
- Abnormal vibrations or noises are generated when rotating (there are friction noises, contact noises, knocking noises, impeller deflection vibrations, etc.)
- The motor part is abnormally hot and produces a burnt smell.
- The power cord is bent and damaged.
- When touching the power cord, the impeller may rotate or not rotate in an unstable state.

**If any abnormality occurs, please stop using it immediately!**

Immediately pull out the power plug from the socket, and contact the store where you purchased the product or the Customer Service registered in the terms of after-sales service.

# CLEANING AND MAINTENANCE

## Maintenance

During maintenance, the power plug must be pulled out from the socket.

## Main Unit

Wipe clean with a soft cotton cloth.

If the stain is difficult to remove, please soak the cotton cloth with neutral detergent, then wring it out to wipe off the stain, and finally dry the unit gently.

### CAUTION

- Do not use thinner, alcohol, or detergents containing benzene. It may cause deterioration, discoloration, etc.
- When using chemical wipes, follow precautions.
- Do not use sprays (insecticides, fragrances, etc.). It may cause deterioration, discoloration, etc.

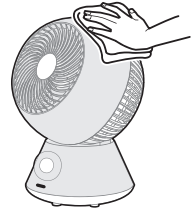

## Guard Cleaning

- Regularly use the vacuum cleaner to vacuum up the dust and so on. Once dust accumulates, it may cause the motor to overheat or produce abnormal noise.
- If there is too much dirt, please remove the front guard, rear guard and impeller for maintenance.
- After maintenance, please install the front guard, rear guard and impeller in place.
- The overall cleaning can be carried out after the front guard, rear guard, impeller, rotary fastener, nut and motor bridge are removed. After cleaning with water, it should be fully dried before being installed in place.

## Removal Method

### ⚠ CAUTION

Do not operate with the guard removed. There is a possibility of personal injury.

- 1 The impeller is horizontal. Remove the screws before rotating open the front mesh cover.

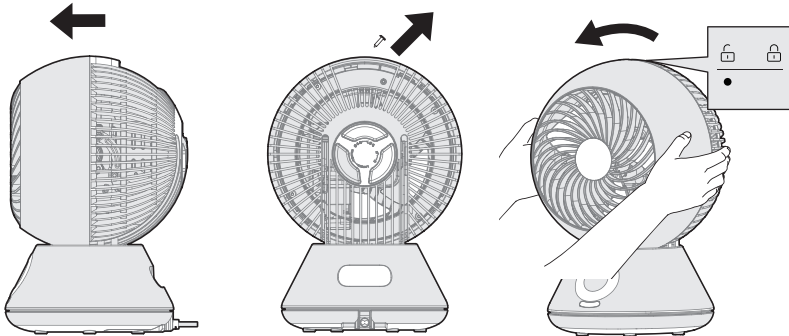

- 2 Turn the rotary fastener to the right to remove the fastener and impeller. Align the lock symbol with the lock symbol on the top surface of the front grille, and remove the front grille.

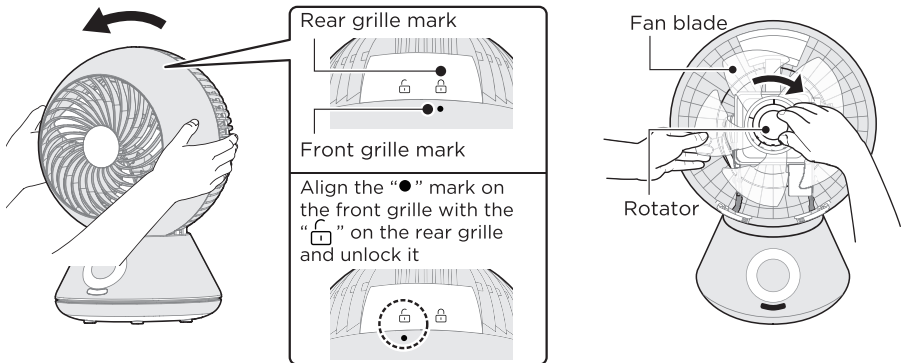

- 3 Open the front guard lock rod outward and turn it to the back of the body. Then support the rear grille with one hand, rotate the grille fastening nut in the "Unlock" (counterclockwise) direction and remove it. Hold the rear grille with both hands, and be careful not to hang the rear grille lock rod on the body. Pull the rear grille toward you and remove it.

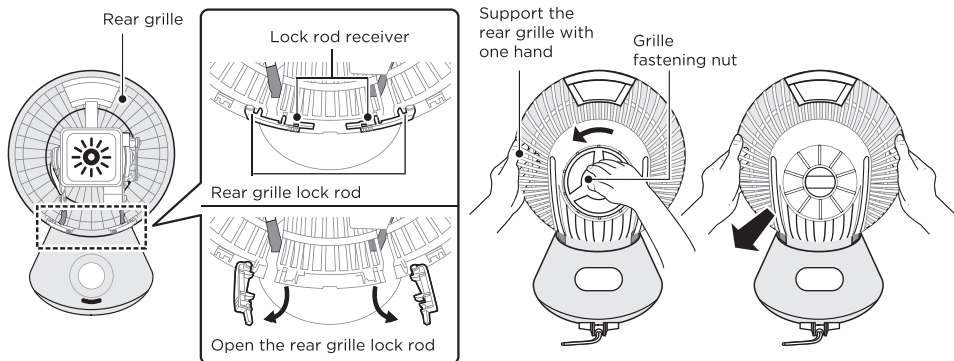

### **⚠ CAUTION**

Paste lubricant is applied around the motor part. Please do not touch it.

## **Installation Method**

- 1 Place the back of the body facing the front. Open the rear grille lock rod to the state where the rear grille lock rod is open. Hold the rear grille with both hands, and be careful not to touch the main body. When inserting the main body, align the hole of the rear grille with the grille nut interface of the main body and install it. Turn the grille nut clockwise to the "Lock" position to ensure that the rear grille is firmly fixed.

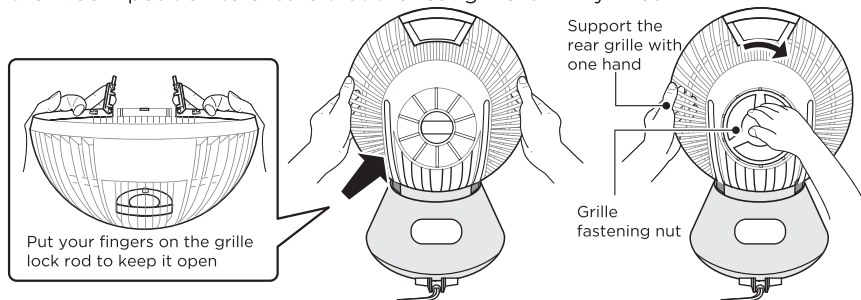

- 2 Place the front of the body facing up. Close the rear grille lock rod to ensure that the rear grille is locked.

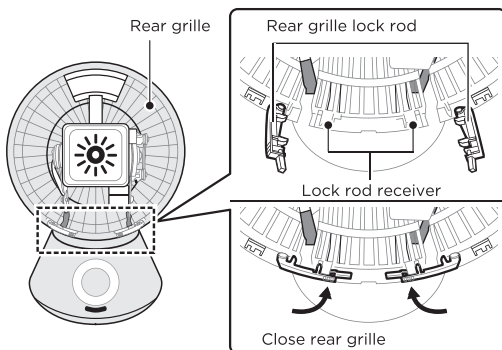

3 Align the notch of the motor shaft with the D-shaped hole shape in the center of the blade and insert the blade to the bottom. The feather below refers to the blade. Remember to correct it.

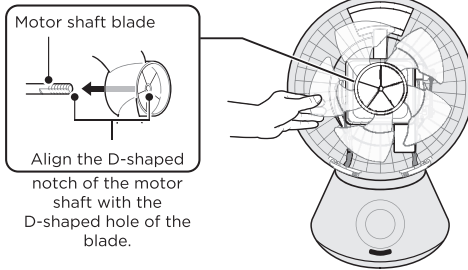

4 With the “●” mark on the front grille facing up, hold it with both hands, and align the “●” mark with the “🔒” mark of the rear grille. Turn the “●” mark on the front grille clockwise to align with the “🔒” mark of the rear grille.

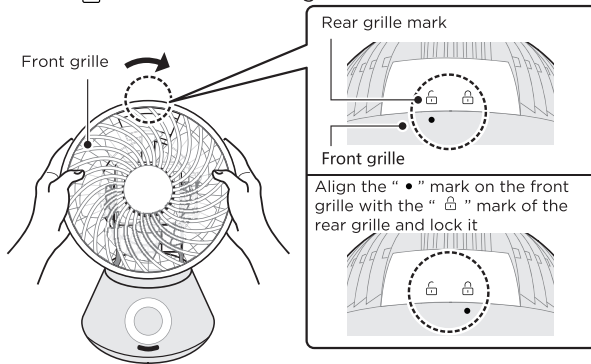

**NOTE**

- Make sure that the “●” mark of the front grille and the “🔒” mark of the rear grille are correctly aligned.
- The grille may fall off during operation.
- After cleaning, wait for the body to dry before using it.

5 Finally, use screws to secure the front and rear mesh covers at the handle of the fuselage.

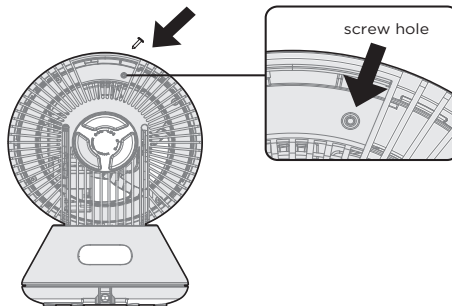

**Storage**

After cleaning, pay attention to the following points and store it properly.

- Please carefully wipe off the dirt and grease on the body and blades. Resin can cause discoloration and breakage.
- Please put it in a box or pack it in a plastic bag when purchasing and keep it properly.
- Please store it in a place without direct sunlight and with low humidity.

## User Servicing Instructions

- a) Grasp plug and remove from the receptacle or other outlet device. Do not unplug by pulling on cord.
- b) Open fuse cover. Slide open fuse access cover on top of attachment plug towards blades. (Fig. ①)
- c) Remove fuse carefully. Insert the tip of your tool into fuse slot (close with the terminal), then pry the fuse gradually and slowly, but do not overexert. If you feel resistance, you can try it at several times and pry the fuse little by little. When one side of the fuse has been released, then you can get the fuse out entirely. (Fig. ②)
- d) Risk of fire. Replace fuse only with 2.5 Amp, 125 Volt fuse. (Fig. ③)
- e) Close fuse cover. Slide closed the fuse access cover on top of attachment plug. (Fig. ④)
- f) Risk of fire. Do not replace attachment plug. Contains a safety device (fuse) that should not be removed. Discard product if the attachment plug is damaged.
- g) If the fan suddenly does not work during normal operation, please check whether it is a problem with the fuse.

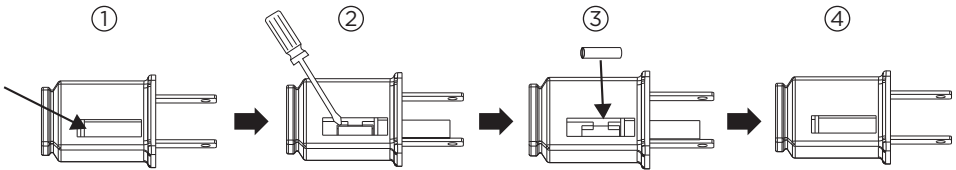

### NOTE

- When you replace the fuse, please don't operate suddenly or overexert, or else the product will be damaged or cause accident.
- When you feel it hard to be operated, please make sure you have got the right way.
- Risk of fire. Do not replace attachment plug. Contains a safety device (fuse) that should not be removed. Discard product if the attachment plug is damaged.

# TROUBLESHOOTING

Operation of your appliance can lead to errors and malfunctions. The following tables contain possible causes and notes for resolving an error message or malfunction. It is recommended to read the tables carefully below in order to save your time and money that may cost for calling to the service center.

Fault	Measures
Operation failure	<ul style="list-style-type: none"><li>• Is the power plug inserted into the outlet?<ul style="list-style-type: none"><li>- Insert the plug fully into the socket.</li></ul></li></ul>
Cannot operate with the remote control	<ul style="list-style-type: none"><li>• Are the batteries exhausted?<ul style="list-style-type: none"><li>- Reload the battery.</li></ul></li><li>• Is the transmitting part facing the main unit? Or are there any obstacles?<ul style="list-style-type: none"><li>- The operation can only be carried out within the angle range of about 90° left and right at a distance of about 3m without obstacles.</li></ul></li><li>• Has the protective film on the battery been removed?<ul style="list-style-type: none"><li>- When the product leaves the factory, a protective film is inserted to prevent the battery of the remote control from being consumed. Please remove it before use.</li></ul></li></ul>
Loud blowing noise	<ul style="list-style-type: none"><li>• Is there any dust or stains on the guard?<ul style="list-style-type: none"><li>- Clean up the dirt with a vacuum cleaner, etc.</li></ul></li></ul>

If the following problems 2 and 3 occur on the power cord and power plug, or if the stains cannot be cleaned in the case of 1, it may cause electric shock or fire. Please contact the store where you purchased the product.

1. Is there any dirt, rust or dust attached to the power plug?
  - Clean up stains, rust, dust, etc.
2. Is the power cord damaged?
3. During the operation, is there any power failure when moving the power cord?

# TRADEMARKS, COPYRIGHTS AND LEGAL STATEMENT

 Midea logo, word marks, trade name, trade dress and all versions thereof are valuable assets of Midea Group and/or its affiliates (“Midea”), to which Midea owns trademarks, copyrights and other intellectual property rights, and all goodwill derived from using any part of an Midea trademark. Use of Midea trademark for commercial purposes without the prior written consent of Midea may constitute trademark infringement or unfair competition in violation of relevant laws.

This manual is created by Midea and Midea reserves all copyrights thereof. No entity or individual may use, duplicate, modify, distribute in whole or in part this manual, or bundle or sell with other products without the prior written consent of Midea.

All the described functions and instructions were up to date at the time of printing this manual. However, the actual product may vary due to improved functions and designs.

# DATA PROTECTION NOTICE

For the provision of the services agreed with the customer, we agree to comply without restriction with all stipulations of applicable data protection law, in line with agreed countries within which services to the customer will be delivered, as well as, where applicable, the EU General Data Protection Regulation (GDPR).

Generally, our data processing is to fulfil our obligation under contract with you and for product safety reasons, to safeguard your rights in connection with warranty and product registration questions. In some cases, but only if appropriate data protection is ensured, personal data might be transferred to recipients located outside of the European Economic Area.

Further information is provided on request. You can contact our Data Protection Officer via **MideaDPO@midea.com**. To exercise your rights such as right to object your personal data being processed for direct marketing purposes, please contact us via **MideaDPO@midea.com**. To find further information, please follow the QR Code.



*make yourself at home*



[www.midea.com](http://www.midea.com)

© Midea 2022 all rights reserved